

| SERVICES OFFSET SCHEDULE | | | | | | | | | |
|--------------------------------|--------------|-----------------|--------|--------|--------------------|----------------|----------------|-------------|-------------|
| STREET NAME | ROAD RESERVE | BACK OF KERB | SEWER | GAS | NON DRINKING WATER | DRINKING WATER | COMMUNICATIONS | ELECTRICITY | LIGHT POLES |
| ALLEGRO WALK | 5.00 | - | - | 2.35 N | 2.75 N | 3.20 N | 3.65 N | - | - |
| CONTATA GROVE (LOT 301 TO 305) | 15.00 | 5.20 N / 2.20 S | 1.00 N | 2.40 N | 2.90 N | 3.40 N | 1.85 N | 0.80 S | 1.30 S |
| CONTATA GROVE (LOT 307 TO 315) | 18.00 | 5.20 | 1.00 S | 2.10 N | 2.60 N | 3.10 N | 1.85 S | 2.60 S | 4.30 S |
| OPERA WALK | 5.00 | - | - | 2.35 E | 2.75 E | 3.20 E | 3.65 E | - | - |
| ORCHESTRA LANE | 8.00 | 1.00 | 2.50 W | - | - | - | - | 0.50 W | - |
| RHYTHM LANE | 11.00 | 4.00 N / 1.00 S | 2.50 S | - | - | - | - | 1.00 N | - |
| TREBLE STREET | 18.00 | 5.20 | 1.00 E | 2.10 W | 2.60 W | 3.10 W | 1.85 E | 2.60 E | 4.30 W |

NOTE: DRIVEWAYS
 DRIVEWAYS TO LOTS 327 TO 353 ARE 4.8m WIDE OFFSET 0.6m FROM SIDE BOUNDARY.

NOTE: HOUSE DRAINS
 1. HOUSE DRAINS TO LOTS 327 TO 334, 336 TO 343 AND 346 TO 353 TO BE OFFSET 1.0m FROM SIDE BOUNDARY.
 2. HOUSE DRAINS TO LOTS 305 AND 314 TO BE OFFSET 6.0m FROM SIDE BOUNDARY.

NOTE: CONSERVATION RESERVE
 1. THE CONSERVATION RESERVE IS TO BE FENCED PRIOR TO CONSTRUCTION COMMENCING.
 2. NO ACCESS IS PERMITTED EXCEPT FOR CONSTRUCTION OF CONTATA GROVE BATTER.

NOTE: TREE PROTECTION ZONE
 TREE PROTECTION ZONES TO BE FENCED PRIOR TO CONSTRUCTION COMMENCING. NO ACCESS IS PERMITTED WITHIN TREE PROTECTION ZONES.

NOTE: FENCING
 1. VEHICLE EXCLUSION MEASURES WHERE ROADS ABOUT A RESERVE ARE TO FORM PART OF THE LANDSCAPE WORKS.
 2. EXISTING FARM FENCING WITHIN THE WORKS AREA ARE TO BE REMOVED AND DISPOSED OFFSITE.

NOTE: TREES
 EXISTING TREE TO BE REMOVED.

WARNING
BEWARE OF UNDERGROUND SERVICES
 The locations of underground services are approximate only and their exact position should be proven on site.
 No guarantee is given that all existing services are shown. Locate all underground services before commencement of works.
DIAL 1100 BEFORE YOU DIG
 www.1100.com.au

| Rev | Amendment | Des/Dft | App'd | Date | Legend |
|-----|---------------------------|---------|-------|----------|--|
| A | Initial Issue | GP/DP | MG | 26/10/20 | Existing Drainage — H — Ex D — Drainage — H — Gas — G |
| B | Title boundary amendments | GP/DP | MG | 10/12/20 | Existing Sewer — Ex S — Main Drainage — H — Electricity — E |
| | | | | | Existing Gas — Ex G — Communications — T |
| | | | | | Existing Electricity U/G — Ex E — Swale Drain — Drinking Water — DW |
| | | | | | Existing Electricity O/H — Ex O/H — Gas & Water Conduits — GW — Non Drinking Water — NDW |
| | | | | | Existing Communications — Ex T — Direction of Lot Fall — Retaining Wall |
| | | | | | Existing Drinking Water — Ex DW — Direction of Overland Flow — Pavement Treatment |
| | | | | | Existing Non Drinking Water — Ex NDW — Allotment to be Evenly Graded — Structural Fill > 200mm |
| | | | | | Existing Swale Drain — Vehicle Crossings — Concrete Infill |

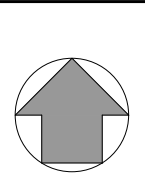

Principal
OCTAVE
 AT JUNCTION VILLAGE
 Jinding Australia
 Level 53, 525 Collins Street
 Melbourne Vic 3000

GPR Consulting
 GPR Consulting Pty Ltd
 ABN 98 140 136 205
 Suite 217, 202 Jells Road
 Wheelers Hill Vic 3150
 Telephone (03) 8544 8400
 © GPR Consulting Pty Ltd

Council City of Casey
 Project **Octave at Junction Village Stage 3**
 Title **Final Design Layout Plan**
 Designed: G.Pratt
 Drafted: D.Pratt
 Authorised: M.Graham
 Date: October 2020

Scale @ A1: 1:500

 Drawing No. **0329-03-F01**
 Sheet 01 of 03
 Rev **B**

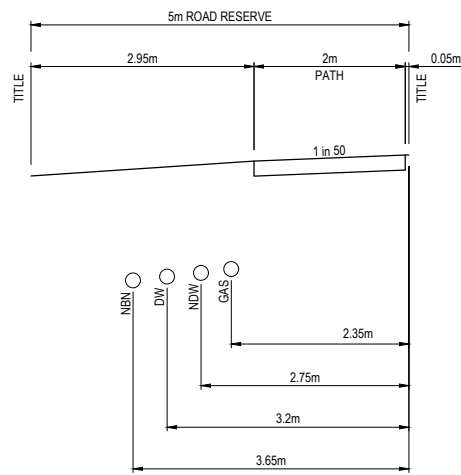

ALLEGRO WALK & OPERA WALK

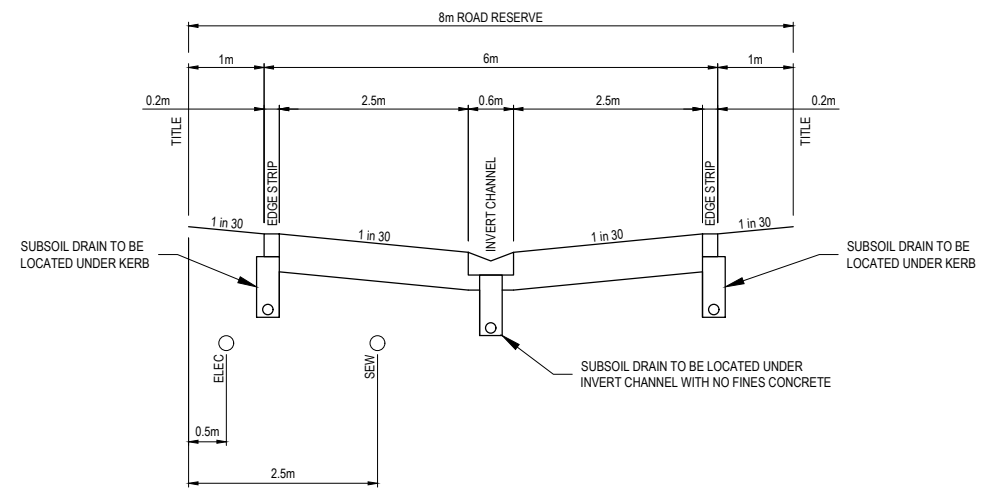

ORCHESTRA LANE

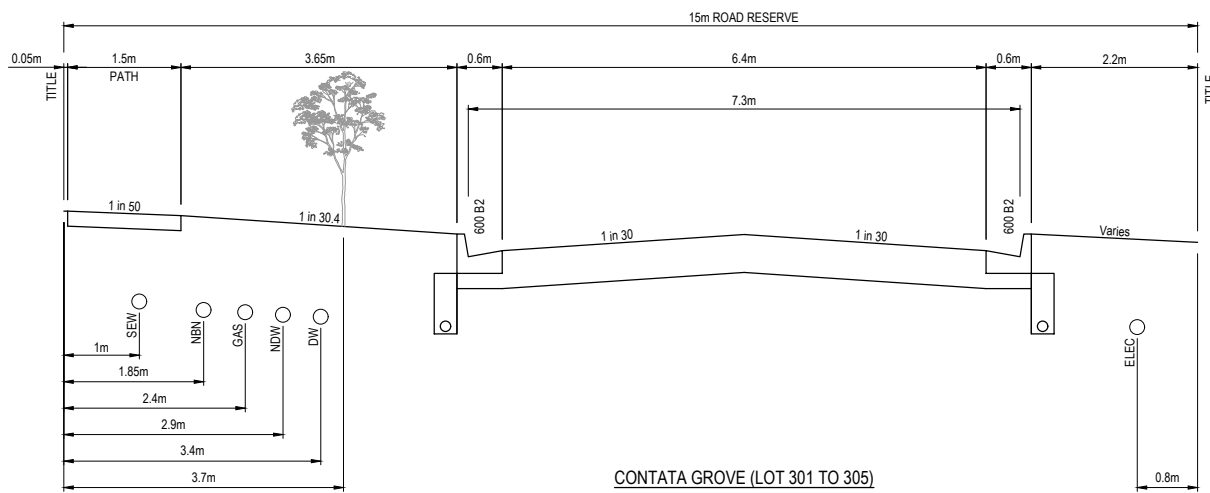

CONTATA GROVE (LOT 301 TO 305)

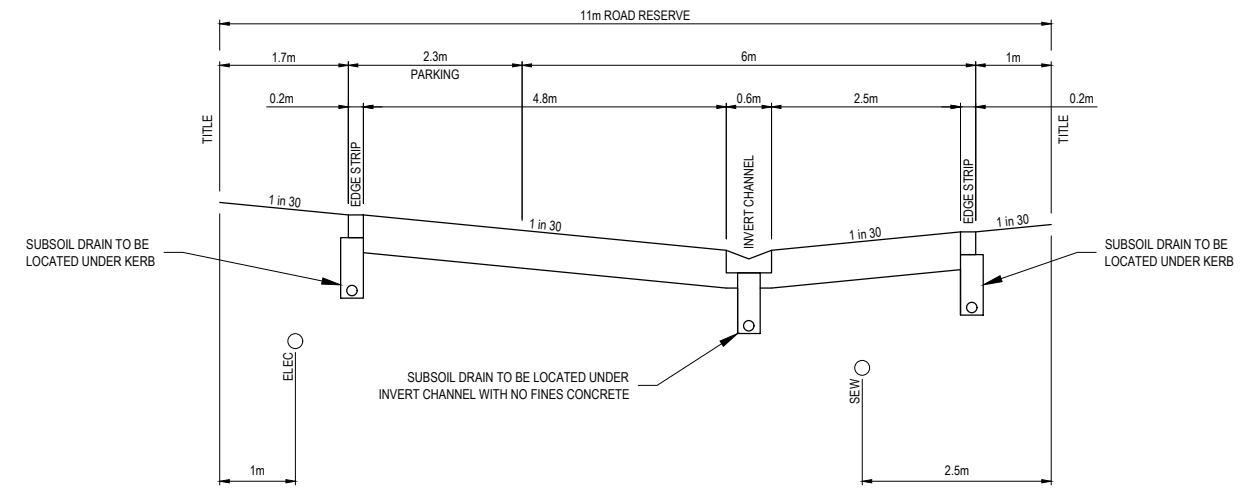

RHYTHM LANE

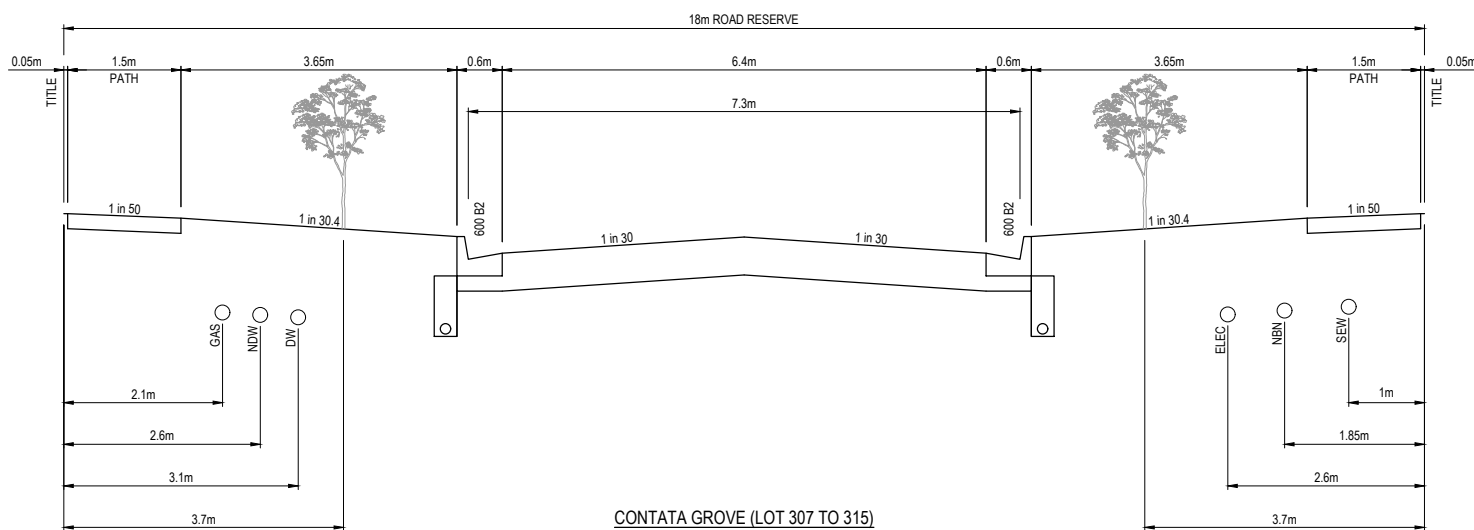

CONTATA GROVE (LOT 307 TO 315)

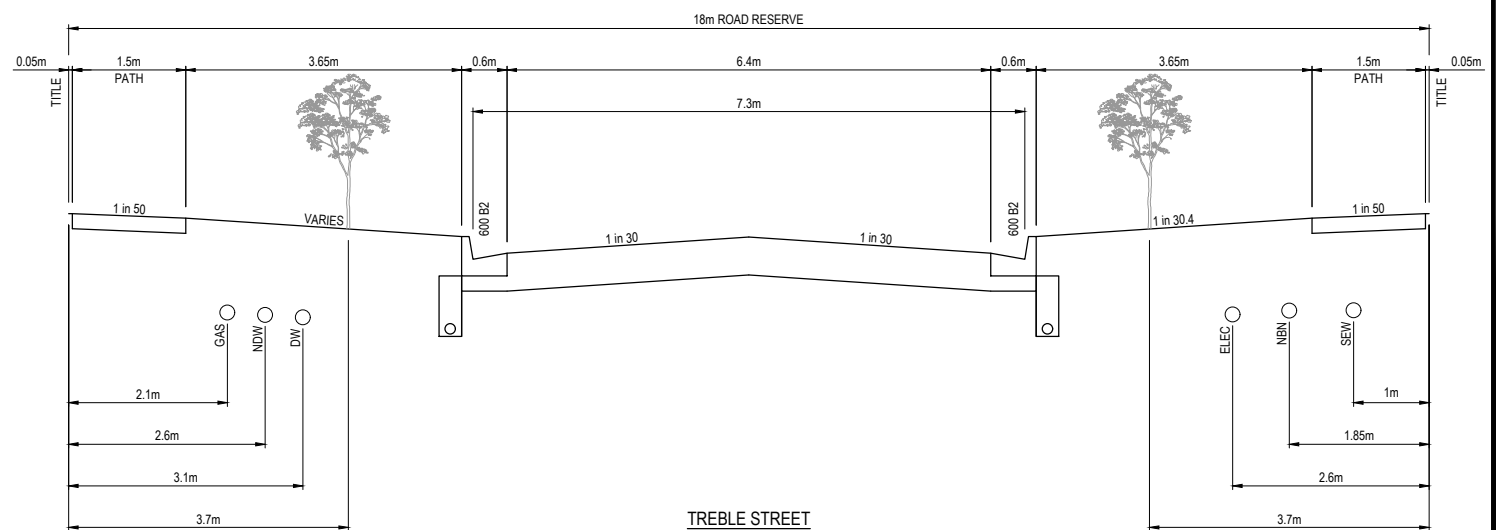

TREBLE STREET

| Rev | Amendment | Des/Dft | App'd | Date |
|-----|---------------------------|---------|-------|----------|
| A | Initial Issue | GP/DP | MG | 26/10/20 |
| B | Title boundary amendments | GP/DP | MG | 10/12/20 |
| | | | | |
| | | | | |
| | | | | |
| | | | | |
| | | | | |
| | | | | |

Principal
OCTAVE
 AT JUNCTION VILLAGE
 Jinding Australia
 Level 53, 525 Collins Street
 Melbourne Vic 3000

GPR Consulting
 GPR Consulting Pty Ltd
 ABN 98 140 136 205
 Suite 217, 202 Jellis Road
 Wheelers Hill Vic 3150
 Telephone (03) 8544 8400
 © GPR Consulting Pty Ltd

Council City of Casey
 Project **Octave at Junction Village Stage 3**
 Title **Functional Design Typical Sections**
 Designed: G.Pratt
 Drafted: D.Pratt
 Authorised: M.Graham
 Date: October 2020

Scale @ A1: H1:50 V1:25

 Drawing No. **0329-03-F02**
 Sheet 02 of 03
 Rev **B**

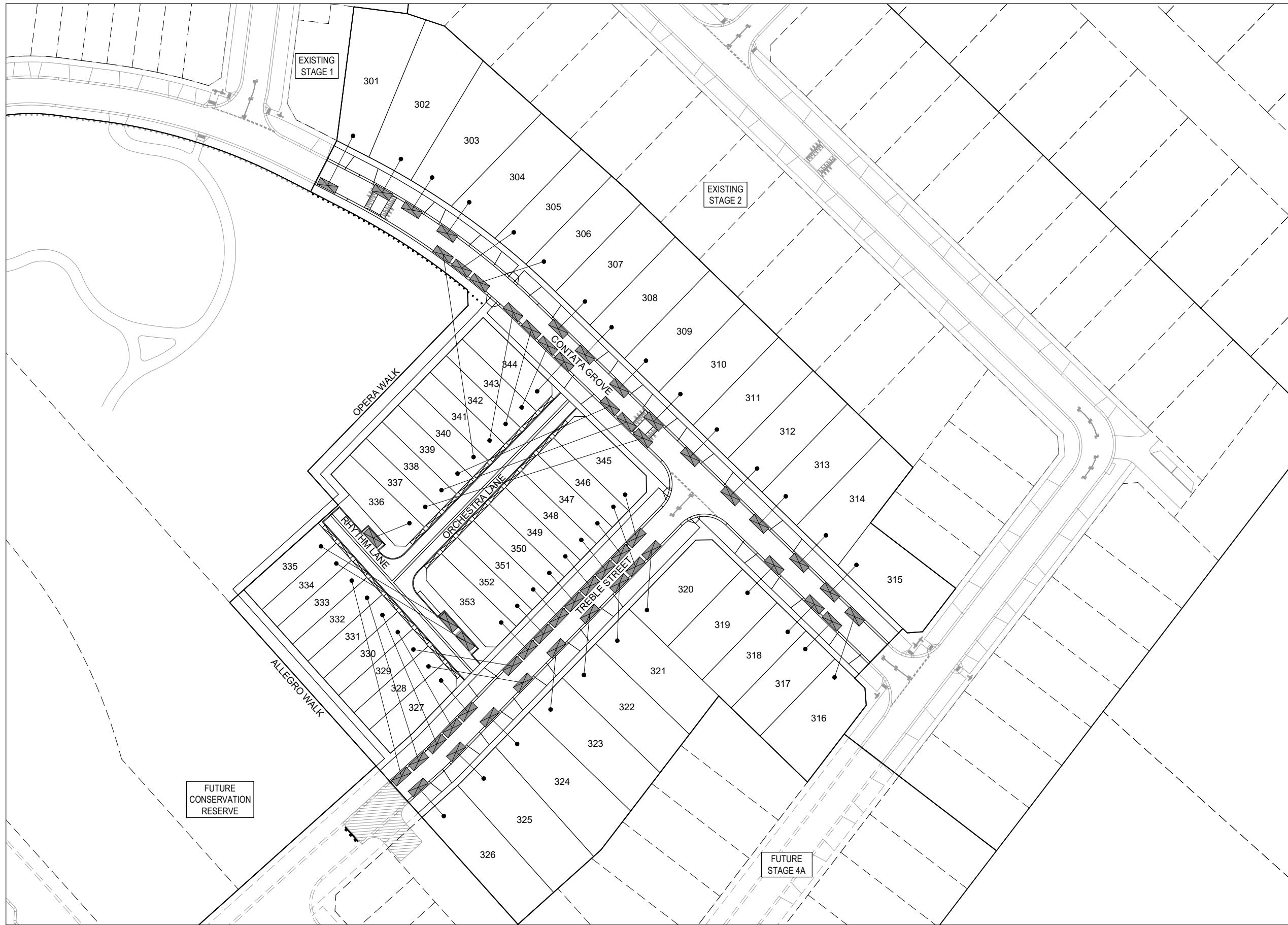

WARNING
BEWARE OF UNDERGROUND SERVICES
 The locations of underground services are approximate only and their exact position should be proven on site. No guarantee is given that all existing services are shown. Locate all underground services before commencement of works.
DIAL 1100 BEFORE YOU DIG
 www.1100.com.au

| Rev | Amendment | Des/Dft | App'd | Date |
|-----|---------------------------|---------|-------|----------|
| A | Initial Issue | GP/DP | MG | 26/10/20 |
| B | Title boundary amendments | GP/DP | MG | 10/12/20 |
| | | | | |
| | | | | |
| | | | | |

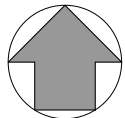

Principal
OCTAVE
 AT JUNCTION VILLAGE
 Jinding Australia
 Level 53, 525 Collins Street
 Melbourne Vic 3000

GPR Consulting
 GPR Consulting Pty Ltd
 ABN 98 140 136 205
 Suite 217, 202 Jells Road
 Wheelers Hill Vic 3150
 Telephone (03) 8544 8400
 © GPR Consulting Pty Ltd

Council City of Casey
 Project **Octave at Junction Village Stage 3**
 Title Functional Design Parking Plan
 Designed: G.Pratt
 Drafted: D.Pratt
 Authorised: M.Graham
 Date: October 2020

Scale @ A1: 1:500

 Drawing No. **0329-03-F03**
 Sheet 03 of 03
 Rev **B**